

HPM120 200 VAC

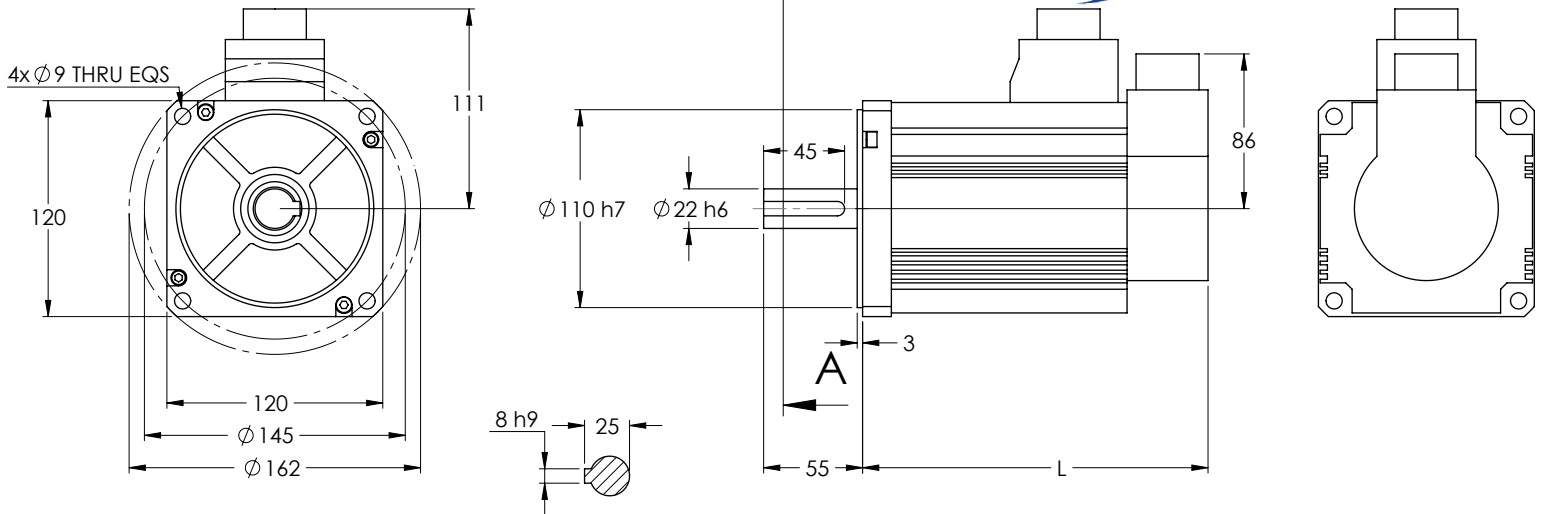

Orbex Group
Revolution In Motion



SECTION A-A

Parameter	Unit	Motor Model		
		HPM120-01-200	HPM120-02-200	HPM120-03-200
Rated Power	kW	2	3	4
Rated Voltage	V	200 (AC)		
Continuous Stall Torque	Nm	6.37	9.55	12.7
Max Torque	Nm	19.1	28.7	38.1
Rated Speed/Max. Speed	rpm	3000/5000		
Rated Current	A _{peak}	11.9	19	26.7
Max Current	A _{peak}	35.7	57	80.1
Back EMF Constant, K _e	V _{peak} /krpm	51.6 (±10%)		47.26
Torque Constant, K _T	Nm/A _{peak}	0.493 (±10%)		.45
Moment of Inertia	x10 ⁻⁴ kg*m ²	4	6.5	8.5
Number of Poles		10		
Mass	kg	6.6	8.4	10.2
L	mm	163	192	221
Feedback Options		-01:Optical encoder (2500 line) /-02: Magnetic encoder (1024 line)		
Operating Environment		Temperature: 0-40°C; Humidity: ≤95% RH, Non-condensing		
Storage Environment		Temperature: -20-65°C; Humidity: ≤95% RH, Non-condensing		
Insulation Rating		Class F (155°C Winding Temperature)		
Protection Class		IP65		
Duty Cycle		Continuous		

HPM120 200 VAC Typical Speed/Torque Curves

